

FIRST FLOOR

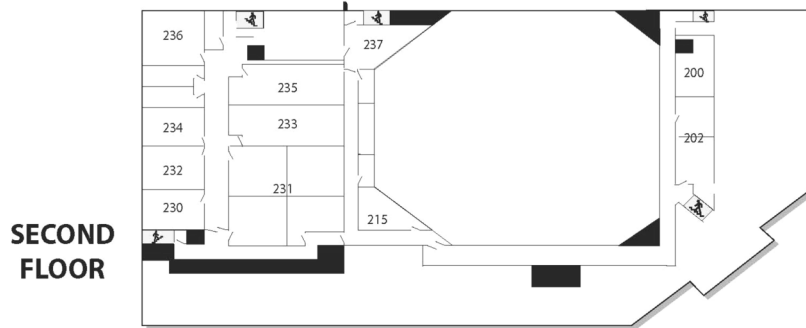

SECOND FLOOR



More Information Contact

Dr. Blake Ring
 Pastor of Missions and Small Groups

bring@naobc.org
 (502) 493-3939

Sunday Morning Schedule

9:00 BFG / Worship
 10:30 BFG / Worship

SPRING 2021

BIBLE FELLOWSHIP GROUPS
 GROW - KNOW - SHOW - GO



What is a Bible Fellowship Group?

Bible Fellowship Groups (BFGs) are our small group Bible studies that gather on Sundays. BFGs offer a setting for you to learn about God's Word through an interactive Bible study lesson. They also provide an opportunity for you to develop intimate relationships within a smaller community of believers. Whatever your age or stage of life, there is a BFG for you and every member of your family.

The name "Bible Fellowship Group" was selected because it focuses on two elements that are crucial for a healthy church - the Bible and fellowship. First, BFGs are centered around a Bible study that is applicable for everyday life. You will be given the opportunity to ask questions and learn from others within the group. BFGs are also designed to meet the needs of both new and mature believers. Second, BFGs are geared to foster fellowship by allowing you to spend time connecting with a small group of believers. In this setting, you will find encouragement, friendship, and prayer support.

When and where do Bible Fellowship Groups gather?

Our BFGs meet on Sunday mornings at 9:00 and 10:30. All of our BFGs gather on our church campus.

How do I find a Bible Fellowship Group?

There are a number of ways to gain more information about our different BFGs. First, additional ministry specific brochures with descriptions of the BFGs are located in both lobbies. Second, if you arrive at church and are not sure which BFG to attend, our greeters will be happy to provide you information and escort you to an appropriate BFG. Third, Pastor Blake Ring (bring@naobc.org) oversees the BFG Ministry and he can provide you direction on your BFG options. Fourth, visit the Small Groups tab online @ naobc.org.

Preschool

Babies	135	9 & 10:30	
1 yr. olds	133	9 & 10:30	
2 yr. olds	134	9 & 10:30	
2 yr. olds & 10:30		136	9
3 yr. olds	132	9 & 10:30	
4 yr. olds	130	9 & 10:30	

Children

K—2 Kid's Worship	231	9:00	
Kindergarten	236	10:30	
1st Grade	234	10:30	
2nd Grade	231	10:30	
3rd Grade	232	9 & 10:30	
4th Grade	230	9 & 10:30	
5th Grade	215	9 & 10:30	

Youth

233/235 9 & 10:30

Singles

College-Age (Braun/Howell)	202	9:00	
Singles (LeonMachado/Faulkner)	202	10:30	

Young Couples (20-35)

YC 2 (McCollum/Cable)	116	10:30	
YC 3 (Pickwick/Smith)	114	10:30	
YC 6 (Graham/Shuba)	124	10:30	
YC 7 (Cook/Hardy)	110	9:00	

Intermediate Couples (35-50)

IC 1 (Amyx/Ring)	100	9:00	
IC 4 (Kantorski/Austin)	100	10:30	
IC 5 (Soto/Hinerman)	124	9:00	
IC 6 (Chitty/Riley)	112	10:30	

Advanced Couples (50-65)

AC 1 (Pisacrita/Sims)	112	9:00	
AC 2 (Hulon/Elieff)	120	9:00	
AC 3 (Sizemore/Cabal)	110	10:30	
AC 4 (Maupin/Roberts)	120	10:30	

Women (Cook/Booth/Bump) 118 10:30

Men (Farris/Padgett/Zakeri) 200 10:30

Senior Adults (Buchanan/Sims) 114 9:00

Senior Women (Sirles) 118 9:00

